

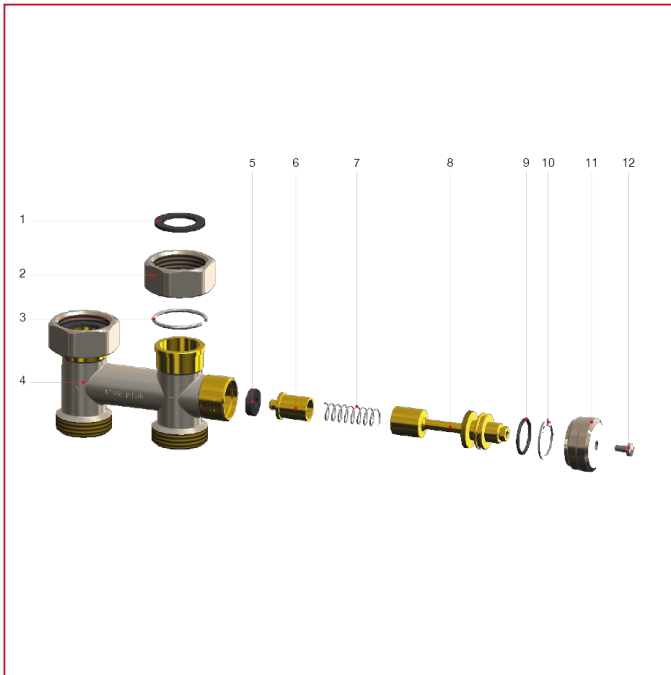

SET POINT REGULATING UNIT

949BY Primary circuit by-pass kit

MATERIALS



POS.	DESCRIPTION	N.	MATERIAL
1	GP EPDM 30 X 20 X 2	2	EPDM
2	NICKEL-PLATED NUT 1" H=17MM	2	CW617N
3	ELASTIC RING 28,5 X 2	2	AISI 304
4	BY-PASS BODY 1"	1	CW617N
5	GP EPDM 16 X 06 X 04	1	EPDM
6	BY-PASS SHUTTER	1	CW614N
7	SPRING 10 X 4 X 0.8 L=33	1	AISI 304
8	BY-PASS STEM M22X1	1	CW614N
9	OR EPDM 18.00 X 02.00	1	EPDM
10	ELASTIC RING FOR D. 23 HOLE	1	AISI 304
11	By-pass handle	1	CW614N
12	SCREW M4 X 7	1	STEEL