



# THERMOSTATIC CONTROL HEADS

## 891SD Thermostatic control head with remote sensor

### INSTRUCTIONS

#### OPERATING FEATURES:

Liquid expansion head.

Setting range: from 6,5°C (\*) to 28°C (5).

Hysteresis: 0,5 K.

Response time (Z): 30 min.

Water temperature effect (W): 0,75 K.

Heat element inalterability range: -15°C/ +60°C.

Possibility of limiting and blocking the setting.

The intermediate setting is "3".

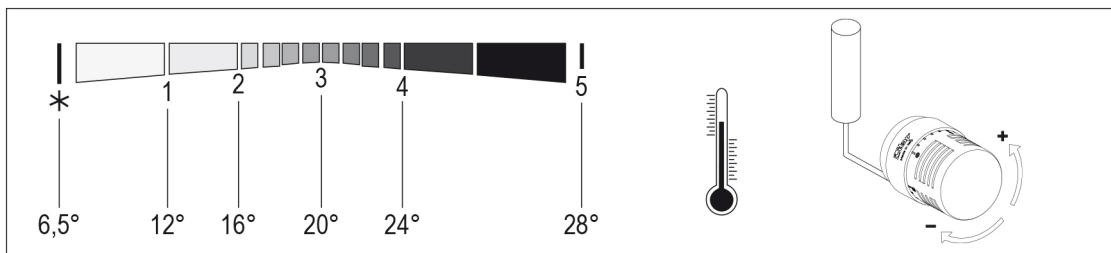

#### INSTALLATION (FIG.I):

Remove the manual adjustment cover (a).

Position setting on 5.

Fit the head to body screwing down manually the toothed ring.

#### LIMITING AND LOCKING THE SETTING:

Set the head in the required position ex.(3).

Use a screwdriver to disassemble the cover (b), the locking cap (c) and the first of the toothed washer (d) FIG. II.

Reassemble the washer (d) as in FIG. III if you want to limit the setting from \* to 3.

Reassemble the washer (d) as in FIG IV if you want to block the setting at the value of 3.

Then reassemble the locking cap (c) and the cover (b).

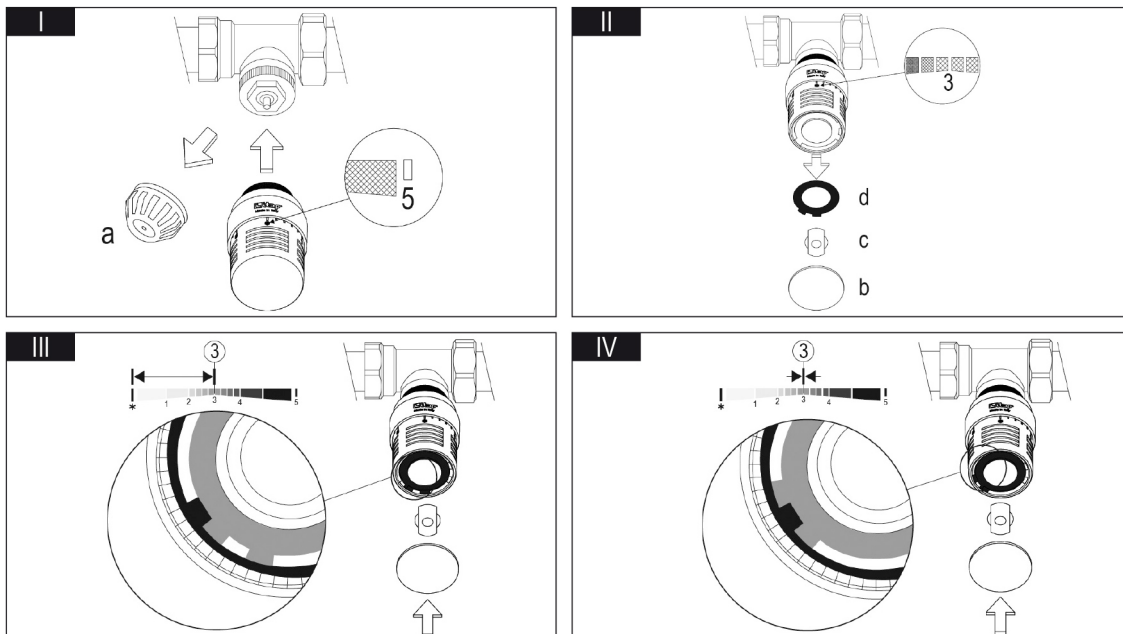

#### NOTES:

For the circuit to work properly, we recommend installing a differential pressure valve between supply and return.



## THERMOSTATIC CONTROL HEADS

To avoid excessive noisiness in the circuit, avoid thermostatic valves with  $\Delta p$  values greater than 0,2 - 0,25bar.

