

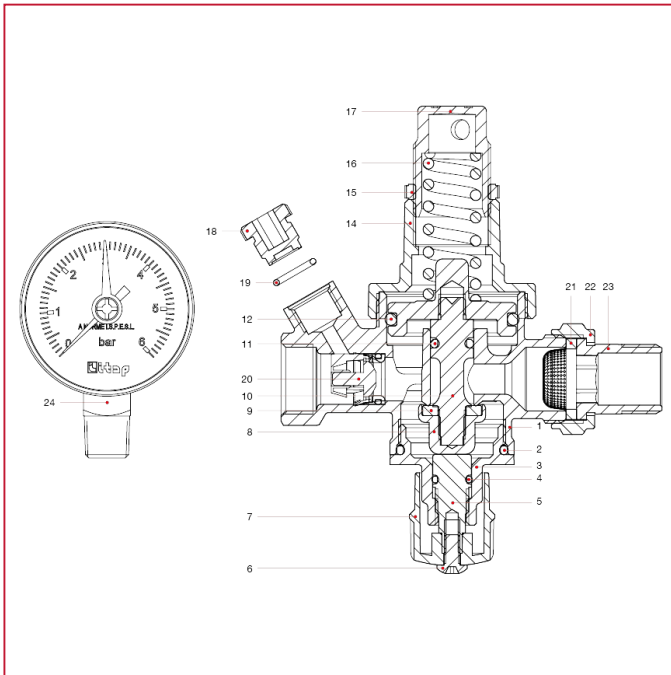

AUTOMATIC FILLING UNIT

146 Automatic filling unit

MATERIALS art.146



POS.	DESCRIPTION	N.	MATERIAL
1	Body	1	Nickel-plated brass CW617N
2	O-ring	1	EPDM
3	Bottom plug	1	Nickel-plated brass CW617N
4	O-ring	1	EPDM
5	Pin	1	Brass CW614N
6	Screw	1	Zinc-plated steel C4C
7	Handle	1	ABS
8	Shutter	1	Brass CW614N
9	Flat seat washer	1	EPDM
10	Stem	1	Brass CW614N
11	O-ring	1	EPDM
12	O-ring	1	EPDM
13	Diaphragm	1	Brass CW617N
14	Upper plug	1	Nickel-plated brass CW617N
15	Nut	1	Nylon
16	Spring	1	EN 10270-1 DH
17	Regulator	1	Brass CW617N
18	Cap	1	POM
19	O-ring	1	EPDM
20	Check valve	1	POM
21	Washer with dome strainer	1	SANTOPRENE-AISI304
22	Nut	1	Nickel-plated brass CW617N
23	Fitting with flat seat	1	Nickel-plated brass CW617N
24	Pressure gauge	1	Brass CW614N



AUTOMATIC FILLING UNIT

MATERIALS art.146SM

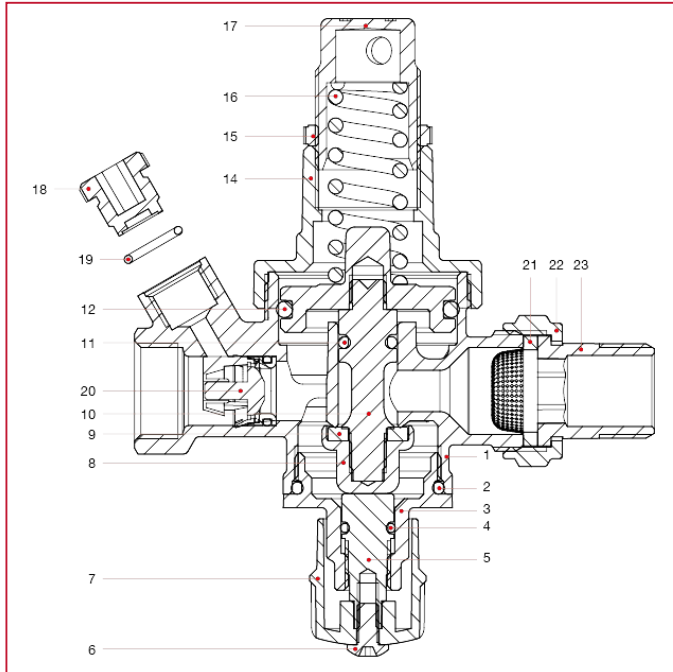

POS.	DESCRIPTION	N.	MATERIAL
1	Body	1	Nickel-plated brass CW617N
2	O-ring	1	EPDM
3	Bottom plug	1	Nickel-plated brass CW617N
4	O-ring	1	EPDM
5	Pin	1	Brass CW614N
6	Screw	1	Zinc-plated steel C4C
7	Handle	1	ABS
8	Shutter	1	Brass CW614N
9	Flat seat washer	1	EPDM
10	Stem	1	Brass CW614N
11	O-ring	1	EPDM
12	O-ring	1	EPDM
13	Diaphragm	1	Brass CW617N
14	Upper plug	1	Nickel-plated brass CW617N
15	Nut	1	Nylon
16	Spring	1	EN 10270-1 DH
17	Regulator	1	Brass CW617N
18	Cap	1	POM
19	O-ring	1	EPDM
20	Check valve	1	POM
21	Washer with dome strainer	1	SANTOPRENE-AISI304
22	Nut	1	Nickel-plated brass CW617N
23	Fitting with flat seat	1	Nickel-plated brass CW617N