

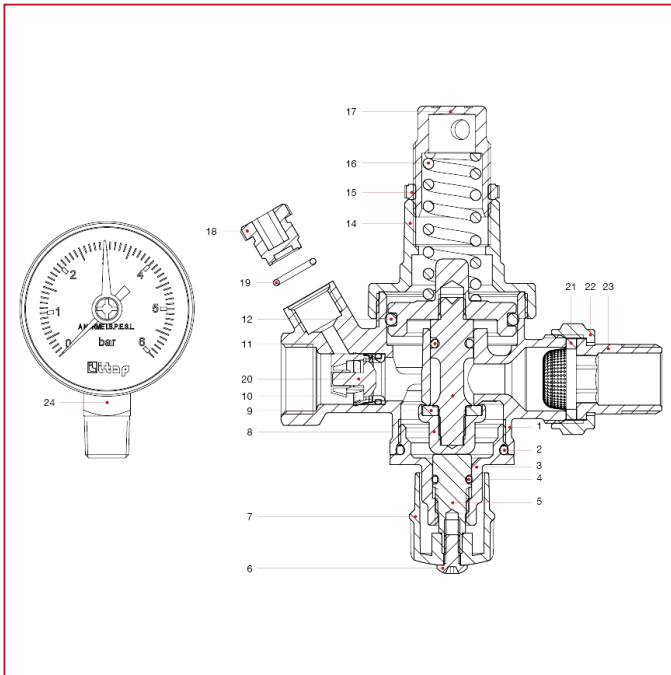

# AUTOMATISCHE FÜLLARMATUR

## 146 Automatische Füllarmatur

### WERKSTOFFE Art.146



| NUM. | BESCHREIBUNG           | Qt | MATERIALIEN                 |
|------|------------------------|----|-----------------------------|
| 1    | Gehäuse                | 1  | Vernickeltes Messing CW617N |
| 2    | O-Ring                 | 1  | EPDM                        |
| 3    | Unterer Verschluss     | 1  | Vernickeltes Messing CW617N |
| 4    | O-Ring                 | 1  | EPDM                        |
| 5    | Stift                  | 1  | Messing CW614N              |
| 6    | Schraube               | 1  | Verzinkter Stahl C4C        |
| 7    | Griff                  | 1  | ABS                         |
| 8    | Verschluss             | 1  | Messing CW614N              |
| 9    | Flachdichtung          | 1  | EPDM                        |
| 10   | Spindel                | 1  | Messing CW614N              |
| 11   | O-Ring                 | 1  | EPDM                        |
| 12   | O-Ring                 | 1  | EPDM                        |
| 13   | Membran                | 1  | Messing CW617N              |
| 14   | Obere Abdeckung        | 1  | Vernickeltes Messing CW617N |
| 15   | Ring                   | 1  | Nylon                       |
| 16   | Feder                  | 1  | EN 10270-1 DH               |
| 17   | Federhaube             | 1  | Messing CW617N              |
| 18   | Kappe                  | 1  | POM                         |
| 19   | O-Ring                 | 1  | EPDM                        |
| 20   | Rückschlagventil       | 1  | POM                         |
| 21   | Filterdichtung         | 1  | SANTOPRENE-AISI304          |
| 22   | Mutter                 | 1  | Vernickeltes Messing CW617N |
| 23   | Flachsitzverschraubung | 1  | Vernickeltes Messing CW617N |
| 24   | Manometer              | 1  | Messing CW614N              |



# AUTOMATISCHE FÜLLARMATUR

## WERKSTOFFE Art.146SM

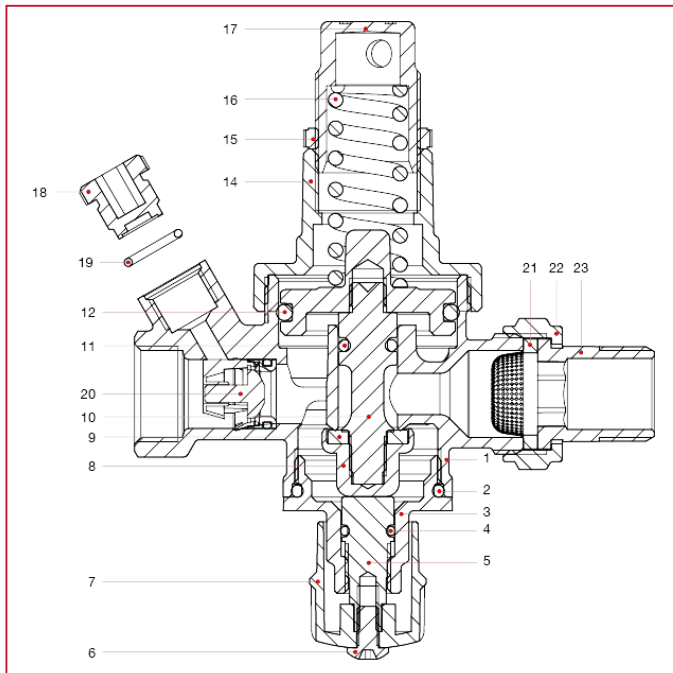

| NUM. | BESCHREIBUNG           | Qt | MATERIALIEN                 |
|------|------------------------|----|-----------------------------|
| 1    | Gehäuse                | 1  | Vernickeltes Messing CW617N |
| 2    | O-Ring                 | 1  | EPDM                        |
| 3    | Unterer Verschluss     | 1  | Vernickeltes Messing CW617N |
| 4    | O-Ring                 | 1  | EPDM                        |
| 5    | Stift                  | 1  | Messing CW614N              |
| 6    | Schraube               | 1  | Verzinkter Stahl C4C        |
| 7    | Griff                  | 1  | ABS                         |
| 8    | Verschluss             | 1  | Messing CW614N              |
| 9    | Flachdichtung          | 1  | EPDM                        |
| 10   | Spindel                | 1  | Messing CW614N              |
| 11   | O-Ring                 | 1  | EPDM                        |
| 12   | O-Ring                 | 1  | EPDM                        |
| 13   | Membran                | 1  | Messing CW617N              |
| 14   | Obere Abdeckung        | 1  | Vernickeltes Messing CW617N |
| 15   | Ring                   | 1  | Nylon                       |
| 16   | Feder                  | 1  | EN 10270-1 DH               |
| 17   | Federhaube             | 1  | Messing CW617N              |
| 18   | Kappe                  | 1  | POM                         |
| 19   | O-Ring                 | 1  | EPDM                        |
| 20   | Rückschlagventil       | 1  | POM                         |
| 21   | Filterdichtung         | 1  | SANTOPRENE-AISI304          |
| 22   | Mutter                 | 1  | Vernickeltes Messing CW617N |
| 23   | Flachsitzverschraubung | 1  | Vernickeltes Messing CW617N |